



## Group Study Rooms

Pfau Library has a total of 10 group study rooms on the upper floors. Most have whiteboards or chalkboards; dry-erase markers and chalk are available at the Reference Desk. Please close the door to keep your conversations from bothering others.

Eight of the rooms are available on a first-come, first-served basis, and two can be reserved. *Group study rooms are only for groups of at least two people!* Individuals cannot "hold" a room for a group, and any individual found occupying a group study room must vacate it if a group arrives.

The library offers locked individual study carrels for graduate students or faculty. We regret that we do not have enough study carrels to offer to individual undergraduates. Inquire about study carrels at the Library Administration office, PL-2006.

## Locations

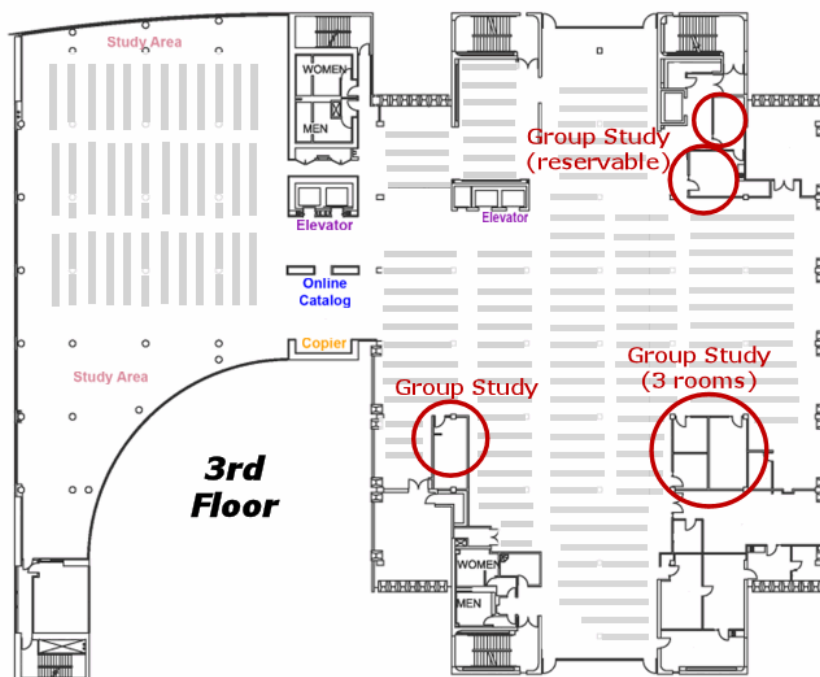

The 3<sup>rd</sup> floor has six group study rooms.

The two rooms to your left as you exit the elevators are locked and require a key, which you can check-out from the Circulation Desk. These two rooms can be reserved ahead of time for groups of 3 or more. Make reservations at the Circulation Desk. PL-321 seats four, PL-323 seats eight.

Complete details are available in the [Group Study Room reservation policy](#) on our web site.

The 4<sup>th</sup> floor has three group study rooms. The large room seats 8-10 people; the smaller rooms seat 4.

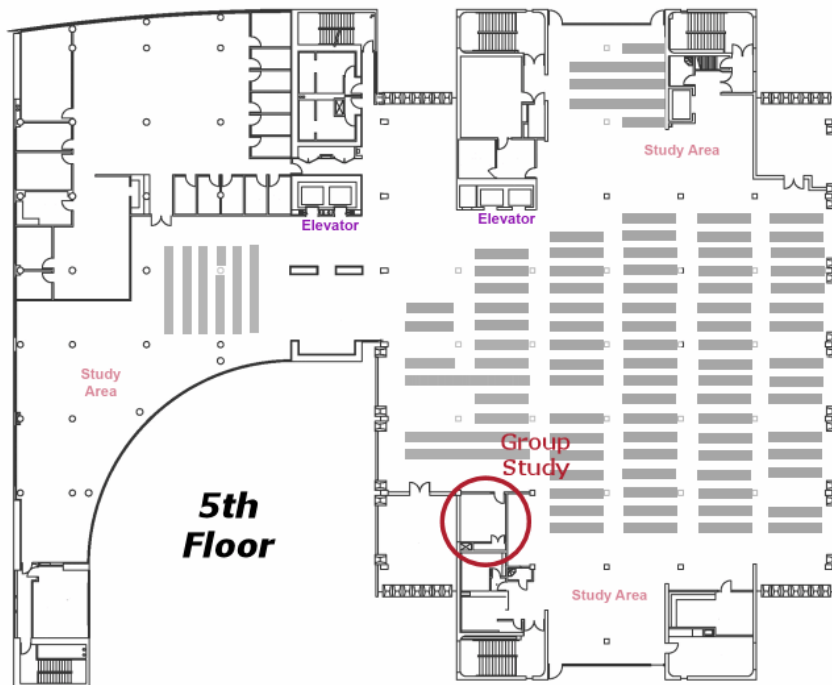
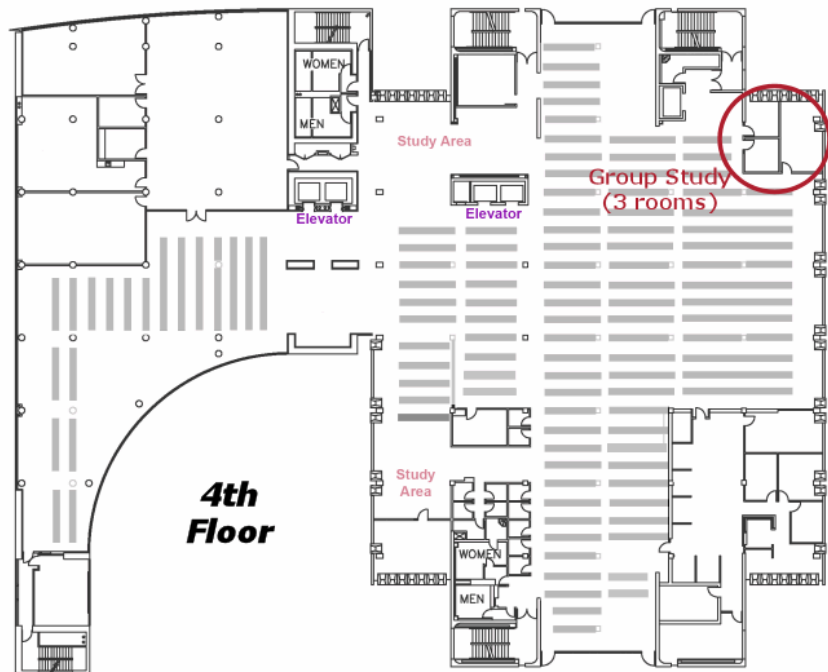

The 5<sup>th</sup> floor has one large group study room which seats 8-10 people.

If you have any questions, please consult a reference librarian or call 537-5091.